

# BMW-Factory Leipzig

**Client:** BMW Group  
**Project:** New building  
**Project Period:** 2001 to 2005  
**Area (Main Floor Area):**  
 Assembly Hall: 100,000 m<sup>2</sup>  
 Bodyshell Work Hall: 70,000 m<sup>2</sup>

## Scope of Services:

- Heating, ventilation, sanitary technology
- Electrical engineering
- Fire-alarm systems
- Fire extinguishing technology
- Work phases 1 to 8 according to HOAI (fee structure for architects and engineers)

## Special Features:

- Pilot project 3D-planning
- Very short implementation time (Planning period 1 year; Construction period 1,3 years)
- Optimized ventilation system
- Optimized fire-alarm system
- Sprinkler under FM-guidelines
- Wall hydrants in integrated sprinkler technology
- Dry risers
- Fire extinguisher



- 1 Bodyshell Work <sup>1)</sup>
  - 2 Paint Shop
  - 3 Assembly <sup>1)</sup>
  - 4 Logistics
- <sup>1)</sup> planned by M+M AG

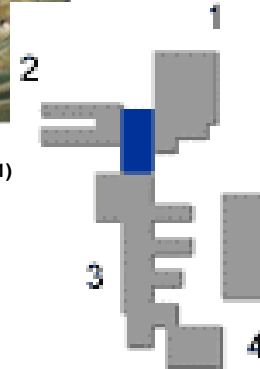

Bodyshell Work



Assembly

